



2019

RRD PRESE RACCORDI RAPIDI INTERCAMBIABILI—SEIRE USA

Materiale: ottone
Guarnizioni Viton
Temperatura esercizio $-20^{\circ}\text{C}/+200^{\circ}\text{C}$
Resistenza ad olio, gas, acidi, basi
Intercambiabilità: DME



SENZA VALVOLA	CON VALVOLA		d1	d2 acqua	d3	d4	L	L1
PRESE portagomma								
RRD6	RRD6V		7	9	17	9	56	27
RRD9	RRD9V		10	13	23	13	68	29
RRD690	RRD690V	90°	7	9	17	9	34	17
RRD990	RRD990V	90°	10	13	23	13	39	29
RRD645	RRD645V	45°	7	6	17	9	32	27
RRD945	RRD945V	45°	10	13	23	13	38	29

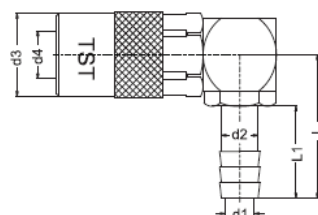
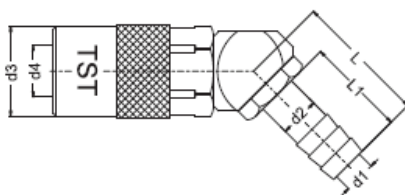
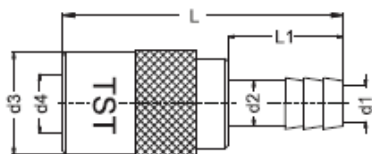

SENZA VALVOLA	CON VALVOLA	RP	d3	d4	L	L1
PRESE fil maschio						
RRD618M	RRD9V18M	BSPT 1/8	17	9	40	30
RRD614M	RRD6V14M	BSPT 1/4			42	
RRD638M	RRD6V38M	BSPT 3/8			42	
RRD914M	RRD9V14M	BSPT 1/4	23	13	52	40
RRD938M	RRD9V38M	BSPT 3/8			57	
RRD912M	RRD9V12M	BSPT 1/2			57	
RRD618M45°	RRD6V18M45°	BSPT 1/8	17	9	38	30
RRD614M45°	RRD6V14M45°	BSPT 1/4			38	
RRD914M45°	RRD9V14M45°	BSPT 1/4			38	
RRD938M45°	RRD9V38M45°	BSPT 3/8	23	13	50	41
RRD912M45°	RRD9V12M45°	BSPT 1/2			50	
RRD618M90°	RRD6V18M90°	BSPT 1/8			50	
RRD614M90°	RRD6V14M90°	BSPT 1/4	17	9	38	30
RRD914M90°	RRD9V14M90°	BSPT 1/4			38	
RRD938M90°	RRD9V38M90°	BSPT 3/8			38	
RRD912M90°	RRD9V38M90°	BSPT 1/2	23	13	50	41
RRD912M90°	RRD9V12M90°	BSPT 1/2			50	
RRD912M90°	RRD9V38M90°	BSPT 1/2			50	

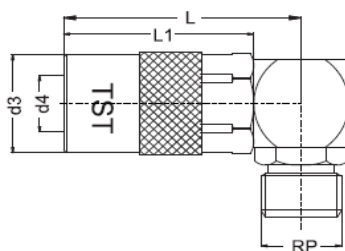
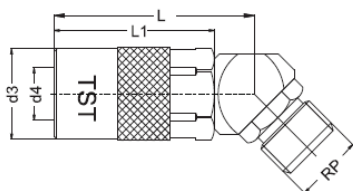



2019

RRD PRESE RACCORDI RAPIDI INTERCAMBIABILI—SEIRE USA

Materiale: ottone
Guarnizioni Viton
Temperatura esercizio $-20^{\circ}\text{C}/+200^{\circ}\text{C}$
Resistenza ad olio, gas, acidi, basi
Intercambiabilità: DME

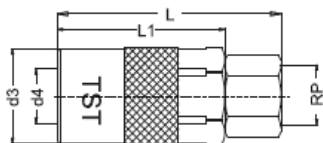

SENZA VALVOLA	CON VALVOLA	RP	d3	d4	L	L1
PRESE fil femmina—BSPT						
RRD618	RRD6V18F	BSP1/8	17	9	42	30
RRD614F	RRD6V14F	BSPT1/4				
RRD638F	RRD6V38F	BSPT3/8				
RRD914F	RRD9V14F	BSPT1/4	23	13	52	40
RRD938F	RRD9V38F	BSPT3/8				
RRD912F	RRE9V12F	BSPT1/2			57	

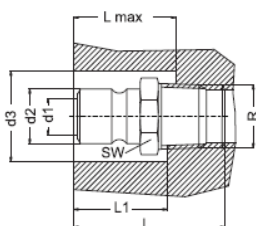

FIL MASCHIO		R BSPT	d1	d2	d3	SW	L1	Lmax	L
SENZA VALVOLA	CON VALVOLA	NIPPLI							
RRDI618		1/8	6	9	22	13	17	18	24
RRDI614		1/4			26	16	19	20	29
	RRDI614V	1/4			28	14	19	21	29
RRDI638		3/8	9	13	30	19	21	22	30
	RRDI638V	3/8			30	17	21	21	29
RRDI918		1/8			26	14	25	26	30
RRDI914		1/4	9	13	23	16	25	26	33
	RRDI914V	1/4			28	14	25	21	33
RRDI938		3/8			30	19	26	28	34
	RRDI938V	3/8	30	17	26	21	33		
RRDI912		1/2	9	13	37	22	26	28	39
	RRDI912V	1/2			32	22	26	27	37
FIL FEMMINA		T	d1	d2	L	SW			
RRDI618F		1/8	6	9	26	13			
RRDI614F		1/4			32	16			
RRDI638F		3/8			32	19			
RRDI918F		1/8	9	13	29	14			
RRDI914F		1/4			37	16			
RRDI938F		3/8			39	19			

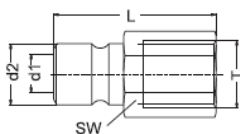



2019

RRD PRESE RACCORDI RAPIDI INTERCAMBIABILI—SEIRE USA

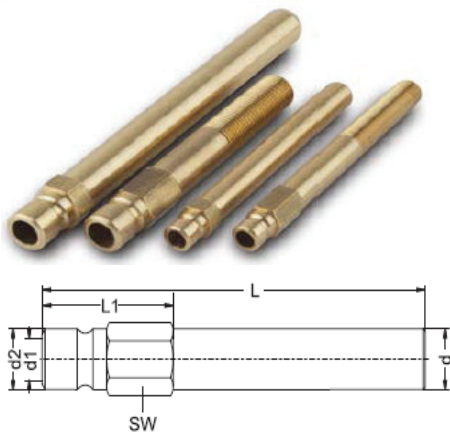

	d1	d2 acqua	SW	(L)	L1
PROLUNGHE RAPIDE					
RREI6 (L)	6	9,4	11	60/100/120/240/360	17
RREI9 (L)	6	13	15	150/300/450	23

RRPRO RPRO PROLUNGHE FILETTATE

MASCHIO FEMMINA	d	R	d2	L	L1	L2	SW
RRPR10BU (L)	1/8	1/8	10	50-75-100-125	12	10	8
RRPR13BU (L)	1/4	1/4	14	50-75-100-125-150	12	10	8
MASCHIO MASCHIO	R	d	d1	L			
RRP6BU (L)	1/8	10	6	50-100-150-200-250			
RRP9BU (L)	1/4	14	9				
RRP12BU (L)	3/8	17	13	100-150-200-250			
RRP16BU(L)	1/2	22	16				