



2019

S330

UNI 5587

Dadi bassi torniti

Materiale: acciaio classe 8.8

Turned short nuts

Material: steel class 8.8

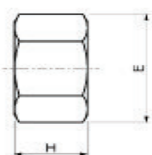
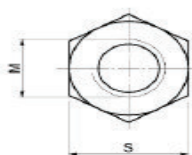

S340

DIN 6330B

Dadi alti torniti

Materiale: acciaio classe 8.8

Turned tall nuts

Material: steel class 8.8

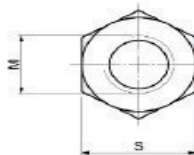

Code	M	S	E	H	gr
S330.08008	8	13	14,8	8	6
S330.10010	10	17	19,6	10	15
S330.12012	12	19	21,5	12	20
S330.14014	14	22	25	14	30
S330.16016	16	24	27,5	16	40
S330.18018	18	27	31	18	60
S330.20020	20	30	34,6	20	80
S330.22022	22	32	36,9	22	95
S330.24024	24	36	41,6	24	135
S330.27027	27	41	47,3	27	195
S330.30030	30	46	53,1	30	275
S330.36036	36	55	63,5	36	465
S330.42042	42	65	75	42	790
S330.48048	48	75	86,5	48	1200

N.B. : Si eseguono su richiesta misure non a catalogo

Code	M	S	E	H	gr
S340.06009	6	10	11,5	9	5
S340.08012	8	13	14,8	12	9
S340.10015	10	17	19,6	15	20
S340.12018	12	19	21,5	18	28
S340.14021	14	22	25	21	45
S340.16024	16	24	27,5	24	58
S340.18027	18	27	31	27	83
S340.20030	20	30	34,6	30	110
S340.22033	22	32	36,9	33	130
S340.24036	24	36	41,6	36	195
S340.27041	27	41	47,3	40	280
S340.30045	30	46	53,1	45	405
S340.36054	36	55	63,5	54	715
S340.42063	42	65	75	63	1170
S340.48072	48	75	86,5	72	1800

N.B. : Other sizes can be supplied on request



2019

S350

Dadi prolungamento

Materiale: acciaio classe 8.8

Extension nuts

Material: steel class 8.8

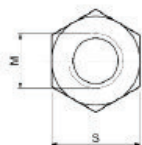

S351

DIN 6331

Dadi con rondella

Materiale: acciaio classe 8.8

Nuts with washer

Material: steel class 8.8

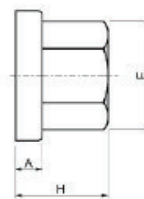
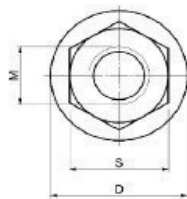

Code	M	S	E	H	gr
S350.06018	6	10	11,5	18	8
S350.08024	8	13	14,8	24	19
S350.10030	10	17	19,6	30	42
S350.12036	12	19	21,5	36	64
S350.14042	14	22	25	42	95
S350.16048	16	24	27,5	48	120
S350.18054	18	27	31	54	170
S350.20060	20	30	34,6	60	240
S350.22066	22	32	36,9	66	280
S350.24072	24	36	41,6	72	400
S350.27081	27	41	47,3	81	600
S350.30090	30	46	53,1	90	850
S350.36108	36	55	63,5	108	1470
S350.42126	42	65	75	126	2340
S350.48144	48	75	86,5	144	3600

Code	M	S	E	H	A	D	gr
S351.00008	8	13	14,8	12	3,5	18	12
S351.00010	10	17	19,6	15	4	22	21
S351.00012	12	19	21,5	18	4	25	36
S351.00014	14	22	25	21	4,5	28	51
S351.00016	16	24	27,5	24	5	31	70
S351.00018	18	27	31	27	5	34	95
S351.00020	20	30	34,6	30	6	37	130
S351.00022	22	32	36,9	33	6	40	160
S351.00024	24	36	41,6	36	6	45	230
S351.00027	27	41	47,3	40	8	51	320
S351.00030	30	46	53,1	45	8	58	470
S351.00036	36	55	63,5	54	10	68	800
S351.00042	42	65	75	63	12	80	1340
S351.00048	48	75	86,5	72	14	92	2040

N.B. : Si eseguono su richiesta misure non a catalogo

N.B. : Other sizes can be supplied on request