

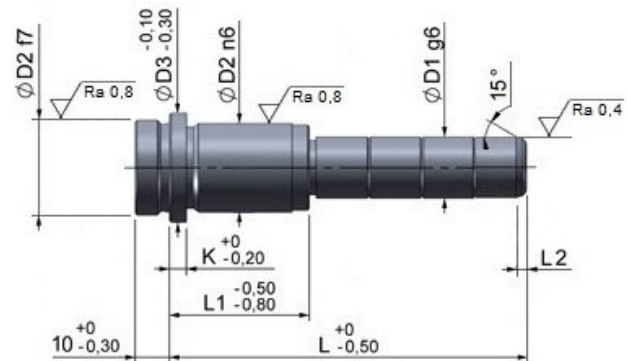

2022

## 56 C COLONNE PRN SPALLATE RINGED ENHANCED LEAD BUSH

Materiale: acciaio UNI 16 CrNi4 n° 5919  
 Trattamento: cementazione e tempra  
 Durezza: superficie Hrc 60-62 -  
 Interno 110-130 da N/mm2  
 Esecuzione: rettifica e lappatura



Stell UNI 16 CrNi4 n° 5909  
 Hardness: Hrc 60-62  
 Execution: carburized, hardened, grinded, lapped

D1	D2	D3	K	X	L1	L														
						50	60	70	80	90	100	120	140	160	180	200	220			
16	22	26	5	10	22	*	*	*	*											
					26	*	*	*	*	*	*	*	*	*						
					36			*	*	*	*	*	*	*						
					46			*	*	*	*	*	*	*	*					
					56				*	*	*	*	*	*	*	*	*	*		
					66					*	*	*	*	*	*	*	*	*	*	
					76						*	*	*	*	*	*	*	*	*	
					96										*	*	*	*	*	
20	28	32	6	10	26		*	*	*	*	*	*	*	*	*	*	*			
					36		*	*	*	*	*	*	*	*	*	*	*	*		
					46			*	*	*	*	*	*	*	*	*	*	*	*	
					56				*	*	*	*	*	*	*	*	*	*	*	
	30°	34°	66					*	*	*	*	*	*	*	*	*	*			
			76						*	*	*	*	*	*	*	*	*			
			86							*	*	*	*	*	*	*	*			
			96								*	*	*	*	*	*	*			
25	34	38	7	10	26			*	*	*	*	*	*	*	*	*				
					36			*	*	*	*	*	*	*	*	*	*			
					46			*	*	*	*	*	*	*	*	*	*			
					56				*	*	*	*	*	*	*	*	*			
	36°	40°			66				*	*	*	*	*	*	*	*	*			
					76					*	*	*	*	*	*	*	*			
					86						*	*	*	*	*	*	*			
					96							*	*	*	*	*	*			
32	40	45	7	10	36			*	*	*	*	*	*	*	*	*				
					46			*	*	*	*	*	*	*	*	*	*			
					56				*	*	*	*	*	*	*	*	*			
					66					*	*	*	*	*	*	*	*			
					76						*	*	*	*	*	*	*			
					86							*	*	*	*	*	*			
					96								*	*	*	*	*			
					106									*	*	*	*			
					116										*	*	*			
					126											*	*			
40	48	52	8	10	146							*	*	*	*	*				
					56							*	*	*	*	*	*			
					66							*	*	*	*	*	*			
					76							*	*	*	*	*	*			
					86							*	*	*	*	*	*			
96								*	*	*	*	*								

° a richiesta



2022

## 57 B BUSSOLE PRL SPALLATE RINGED ENHANCED LEAD BUSH

Materiale: acciaio UNI 16 CrNi4  
 Trattamento: cementazione e tempra  
 Durezza: superficie HRc 60-62  
 interno 110-130 daN/mm2  
 Esecuzione: rettifica e lappatura

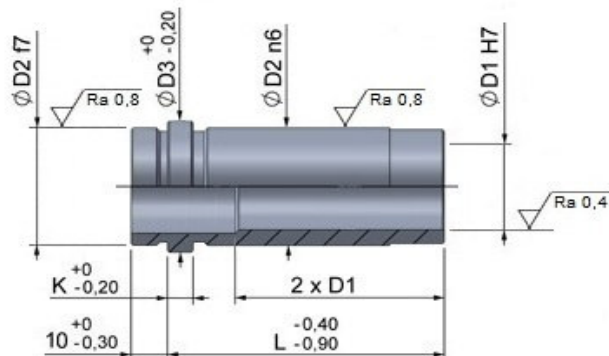

Stell UNI 16 CrNi4 n° 5909  
 Hardness: Hrc 60-62  
 Execution: carburized, hardened, grinded, lapped

D1	16	20		25		32	40
D2	22	28	30*	34	36*	40	48
D3	26	32	34*	38	40*	45	52
K+0-0,2	5	6	7		8		
X	10						
L	16	*	*				
	22	*					
	26	*	*	*			
	36	*	*	*	*		
	46	*	*	*	*	*	*
	56	*	*	*	*	*	*
	66	*	*	*	*	*	*
	76	*	*	*	*	*	*
	86	*	*	*	*	*	*
	96	*	*	*	*	*	*
	106					*	*
	116					*	*
	126					*	*
146					*	*	