



2022

99V

VITI TESTA SVASATA ESAGONO INCASSATO DIN7991 ISO 6761
METRIC COUNTERSUNK SOCKET HEAD SCREW

Materiale: acciaio per viteria 10.9—1.040 N/mm²

Steel:CLASS 10.9 1.040 N/mm²

ALTA RESISTENZA

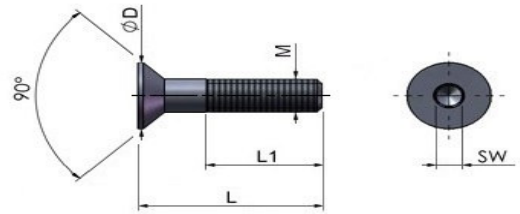

UNI 5933 DIN 7991 - 10.9

M	M3	M4	M5	M6	M8	M10	M12	M14	M16	M18	M20
passo	0,50	0,70	0,80	1	1,25	1,50	1,75		2,00		2,50
D	6	8	10	12	16	20	24	27	30	33	36
sw	1,5	2	2,5	3	4	5	6		8		10
L											
6	*										
8	*	*	*								
10	*	*	*	*	*						
12	*	*	*	*	*						
14	*	*	*	*	*						
16	*	*	*	*	*	*					
20	*	*	*	*	*	*	*				
25	*	*	*	*	*	*	*	*			
30	*	*	*	*	*	*	*	*	*		
35		*	*	*	*	*	*	*	*		
40		*	*	*	*	**	*	*	*	**	*
45			*	*	*	*	*	*	*	**	*
50			*	*	*	*	*	*	*	**	*
55				*	*	*	*	*	*	**	*
60				*	*	*	*	*	*	**	*
70				*	*	*	*	*	*	**	*

98B

BARRE FILETTATE ALTA RESISTENZA
THREADED BARS

Materiale: acciaio UNI 42CrMo4 ASTM A193-B7
 Classe 10.9—Filetto ottenuto x rullatura

Steel:CLASS 10.9 1.040 N/mm² Rolled thread

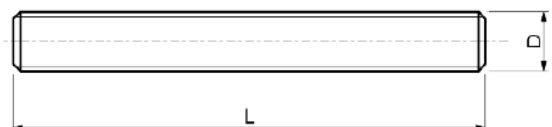

D	L
M6	1000
M8	
M10	
M12	
M14	
M16	
M18	
M20	
M22	
M24	
M27	
M30	
M36	
M42	
M48	